



easykeys.com
fast replacements for office furniture

THE FC10 SERIES ADVANTAGE

HON®



US Patent No:
5,737,950



Replaces HON F24/F28 rotate-style file cabinet locks. Also replaces HON F26 style file cabinet locks when used with FC26-AR optional adapter.



Introducing...The FC10 Series File Cabinet Lock The first pin-tumbler lock for HON® vertical file cabinets.

PIN TUMBLER

Get the security and versatility of a pin tumbler lock for your HON® vertical file cabinets. Pin tumbler locks are more secure and can accommodate up to 2000+ possible keyed different and master keyed key codes. Locks can easily be master keyed or custom keyed to your specifications. Easily provide or restrict access to file cabinet contents by job function or department.

DIRECT RETROFIT

Direct replacement for the HON® F24/F28 vertical file cabinet lock. For use with HON® Series vertical file cabinets produced after 1988 (including HON® Series 1000 vertical file cabinets). Includes all parts necessary for complete lock replacement.

KEYWAY

Locks are available in National D4291/D4292 keyway and are stocked keyed different (KD) or keyed alike (KA) #101, 103, 107 or 915.

EASILY REKEYABLE

Includes patented features for fast and easy rekeying. No need to throw out locks when keys are lost or employees are replaced, simply remove the lock, rekey and replace. It's that easy.

OPTIONAL ADAPTER FOR F26

The FC26-AR adapter ring (available separately) allows the FC10 to retrofit F26 style locks.

OPTIONAL RING PACKAGE

The optional ring package allows you to stamp the key code on a separate ring instead of the face of the lock. This provides maximum flexibility. By not stamping the code on the face of lock, you can simply rekey and change the number ring. Now its easy to rekey... and rekey... and rekey.

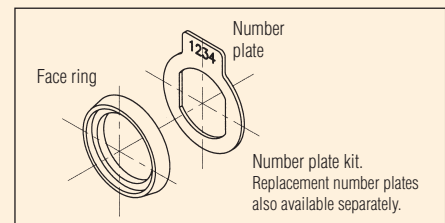

easykeys.com
fast replacements for office furniture

EasyKeys.com

Fast replacements for office furniture

11407 Granite Street | Charlotte, NC 28273

Customer Service: 877-839-5397 | Account Support: 877-839-5390

FC10 Series

Pin Tumbler File Cabinet Lock Kit Assembly and Installation Instructions

Recommended Tools (Fig. 1)

- Flat Bladed Screwdriver
- Phillips Screwdriver
- Narrow Jawed Channel Lock Pliers



Figure 1

Parts – In Order of Assembly (Fig. 2)

- a. Lock Housing
- b. Outer Bezel Ring
- c. Inner Spacer Ring
- d. Nut Retaining Washer
- e. Brass Nut
- f. Inner Cam Stop
- g. Cam
- h. Outer Cam Shifter
- i. Retaining Screw
- j. Connecting Link

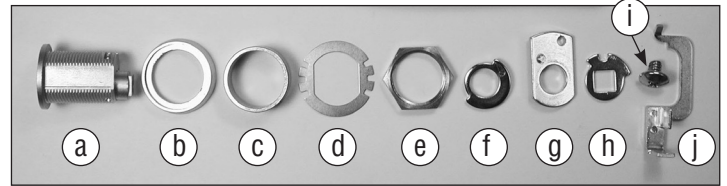

Figure 2

- The file cabinet should be prepared for accepting the lock by having a partially punched $\frac{3}{4}$ inch D-D hole and an internal gang bar installed down the right side of the cabinet. Using your screwdriver and pliers remove the slug from the partially punched hole.
- Slide the outer bezel ring onto the lock housing and insert the housing through the D-D hole. (Fig. 3)
- From the inside install the inner spacer ring, nut retaining washer and brass nut. Do Not Over Tighten Once the nut is firm bend one of the tabs on the nut retaining washer against a flat side of the nut to hold it in place. (Fig. 4)
- With the lock housing installed add the inner cam stop by inserting the small brass pin in the hole supplied in the housing. (Figs. 5 & 6)



Figure 3



Figure 4

- The cam is installed with the side labeled "OUT" facing the rear of the lock. The brass pin travels freely within the notched side of the inner cam stop. (Fig. 7)



Figure 7

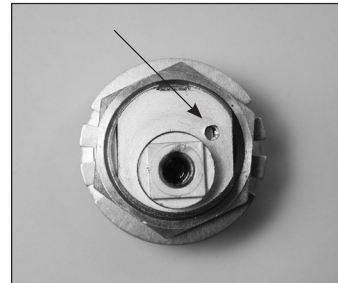

Figure 5



Figure 6

- The outer cam shifter can provide two different functions depending on how it is installed.
 - **"Non Key Retaining" function:** allows the key to be removed in both the locked and unlocked position and the shifter is installed so the brass pin on the cam travels in the long outer notch of the shifter labeled "LM" for lost motion. (Fig. 8)
 - **"Key Retaining" function:** allows you to remove the key in the locked position only and the brass pin of the cam fits into the small inner notch of shifter labeled "KR". (Fig. 9)

Please Note: To correctly synchronize the lock it must be assembled without a key inserted and the cam pointing up in the locked position. (Figs. 8 & 9) Finally, all is secured using the supplied retaining screw.



Figure 8 (non key retaining)

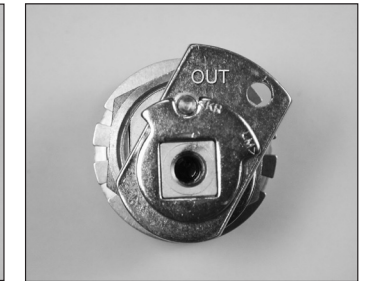

Figure 9 (key retaining)

- You are now able to cycle test the lock for the correct function. The last step will be to install the connecting link between the cam and the file cabinet gang bar. The small hook of the link is inserted into the hole in the cam and the tab end inserted into the hole provided in the bar. To hold the link in place the tab must be bent up at an approximate 45 degree angle using a screwdriver. (Fig. 10)

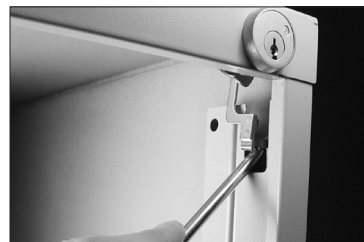

Figure 10

- The lock is now completely installed. The file cabinet is locked with the cam and gang bar raised to the up position. (Figs. 11 & 12)



Figure 11 (locked)



Figure 12 (unlocked)



EasyKeys.com

Fast replacements for office furniture

11407 Granite Street | Charlotte, NC 28273

Customer Service: 877-839-5397 | Account Support: 877-839-5390

easykeys.com
fast replacements for office furniture